

VE4000 Series

CLASS "A" SOLENOID VALVE VE4000B3



FEATURES

- Normally Closed valve. (spring loaded valve disc, closed when de-energized).
- Adjustable flow rate regulator on top of the coil.
- Opening/closing time: <1 sec.
- Maximum working frequency: 20 cycles/min.
- 4 auxiliary pressure taps with Rp 1/4" threaded connections, 2 on the inlet pressure side and 2 on the outlet pressure side.
- Equipped at both sides with mounting holes to adapt a pilot solenoid valve combination Rp 1" (for DN100 Rp 3/4"), to allow either internal or external pilot gas. Optional mounting possibility to adapt an A4021A Valve Proving System.
- Coil field replaceable.
- Coil suitable for permanent energization.
- Coil turnable over 360°.
- Internal fine mesh screen (except DN100).

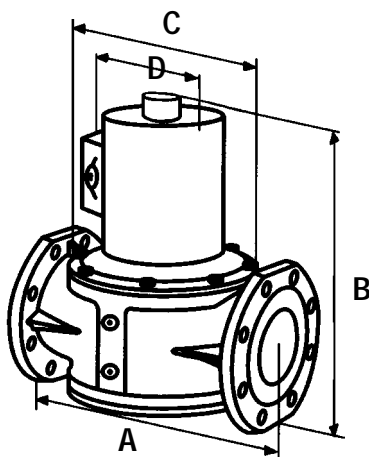

Fig. 3. Dimensional drawing VE4000B3 Series

APPLICATION

These series class "A" gas valves are used for control and regulation of gaseous fluids in gas power burners, atmospheric gas boilers, melting furnaces, incinerators and other gas consuming appliances.

SPECIFICATION

Model

VE4000B3

Dimensions

See figure and table below.

Pipe sizes

Inlet and outlet flange connection DN65, DN80 and DN100 according to PN16 ISO 7005-1.

Mounting and orientation

The valve may be assembled on the pipe line within plus or minus 90 degrees of the vertical axis and 30 cm. air space around the coil assy.

Capacity

See capacity curves VE4000 Series on page 67.

Maximum operating pressure:

DN65, DN80 and DN100 types, 200 or 360 mbar.

Torsion and bending stress

Pipe connections meet group 2, according to EN161, requirements

Supply voltage

Line voltage: 220 ... 240 Vac, 50/60 Hz
110 Vac, 50/60 Hz

Ambient temperature range

-15 ... 60 °C

Electrical connection

Plug connection according to PG11.

Coil insulation solenoid valves

Insulation material according to class F.

Enclosure

IP54

IP65 on request.

Valve body

Aluminium alloy die-cast

Strainer

AISI 303 steel.

Closing spring

AISI 302 steel.

Valve plunger

Chrome plated Fe 360B steel sliding on anti-friction bearing.

Seals and gaskets

Hydrocarbon resistant NBR rubber type.

Optional: Viton rubber type

Standards and Approvals

Class "A" valve in accordance with EN161 standards.

The VE4000 Series gas valves conform with the following EC directives:

- Gas Appliance Directive (90/396/EEC)
PIN: CE-0063AP3075/1
- Low Voltage Directive (73/23/EEC)
- Electro Magnetic Compatibility Directive (89/336/EEC)

Table 3. VE4000B3 Series, Class “A” Normally Closed solenoid valve, ON/OFF with flow rate adjuster and flanged body

O.S. Number	Rated Voltage (Vac)	Passing DN	Maximum Operating Pressure (mbar)	Overall Dimensions (mm)				Power Cons. (W)	Enclosure	Weight (kg)	Bottom Plug
				A	B	C	D				
VE4065B3005	220 ... 240	65	200	310	343	200	148	62	IP54	15	✓
VE4065B3039	220 ... 240	65	360	310	343	200	163	110	IP54	15	✓
VE4065B3013	110	65	200	310	343	200	148	60	IP54	15	✓
VE4065B3062	110	65	360	310	343	200	163	125	IP65	15	✓
VE4080B3004	220 ... 240	80	200	310	343	200	163	118	IP54	15	✓
VE4080B3012	110	80	200	310	343	200	163	125	IP54	15	✓
VE4080B3053	110	80	200	310	343	200	163	220	IP65	15	✓
VE4100B3000	220 ... 240	100	200	350	384	250	185	130	IP54	34.9	-
VE4100B3018	110	100	200	350	384	250	185	129	IP54	34.9	-